

REV	DESCRIPTION	DATE	ORIGINATOR	APPROVED
A	CH083C3T4121DC1	24/08/11		

NOTES:

1. MATERIAL: AL 6063-T5
2. FINISH: BLACK ANODIZED .
3. REMOVE ALL BURRS AND SHARP EDGES.
4.  IS CRITICAL INSPECTION POINT, NUMBERING IN TRIANGLES TO BE USED FOR CROSS REFERENCE OF INSPECTION REPORT TO DRAWING DIMENSION OR FEATURE.

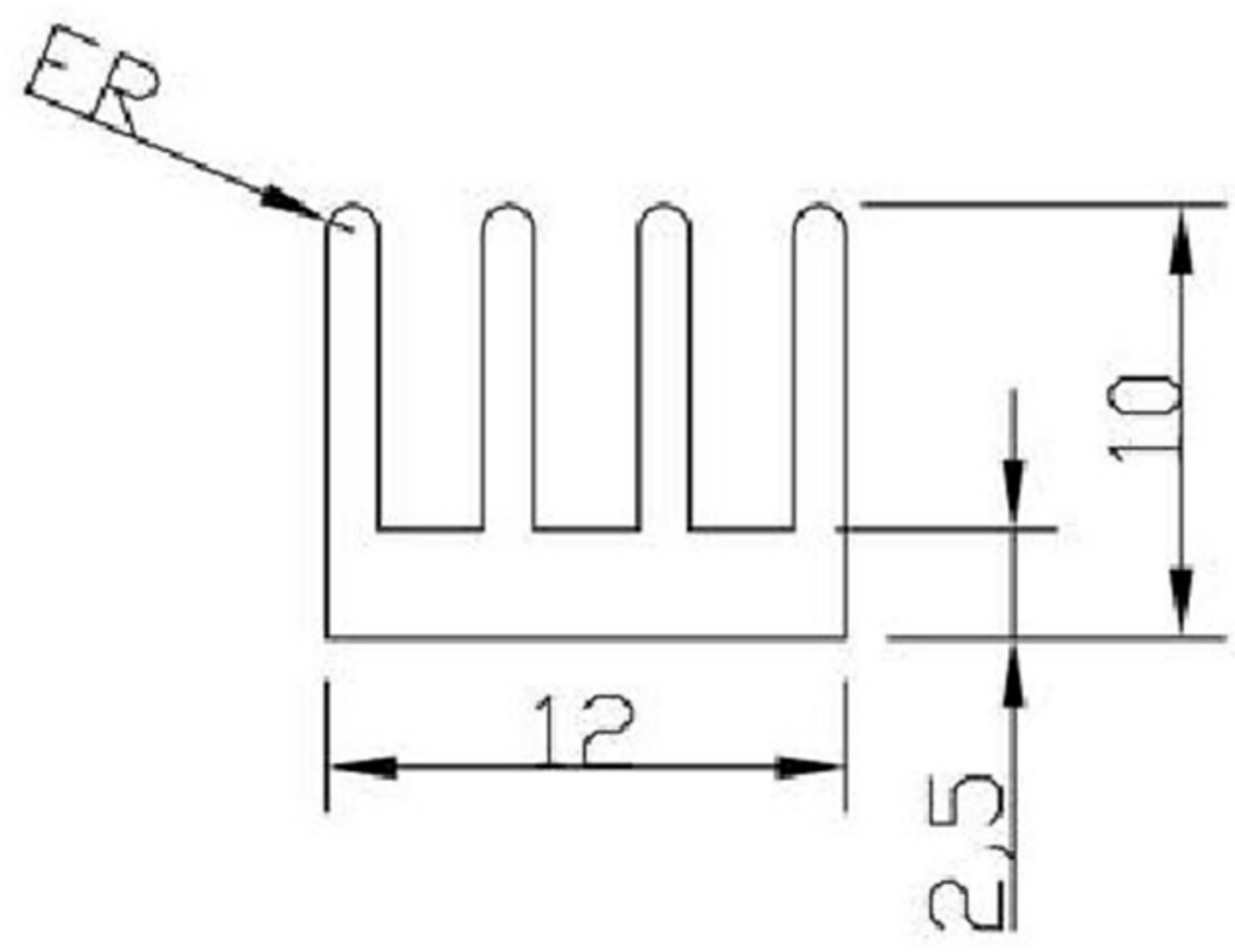
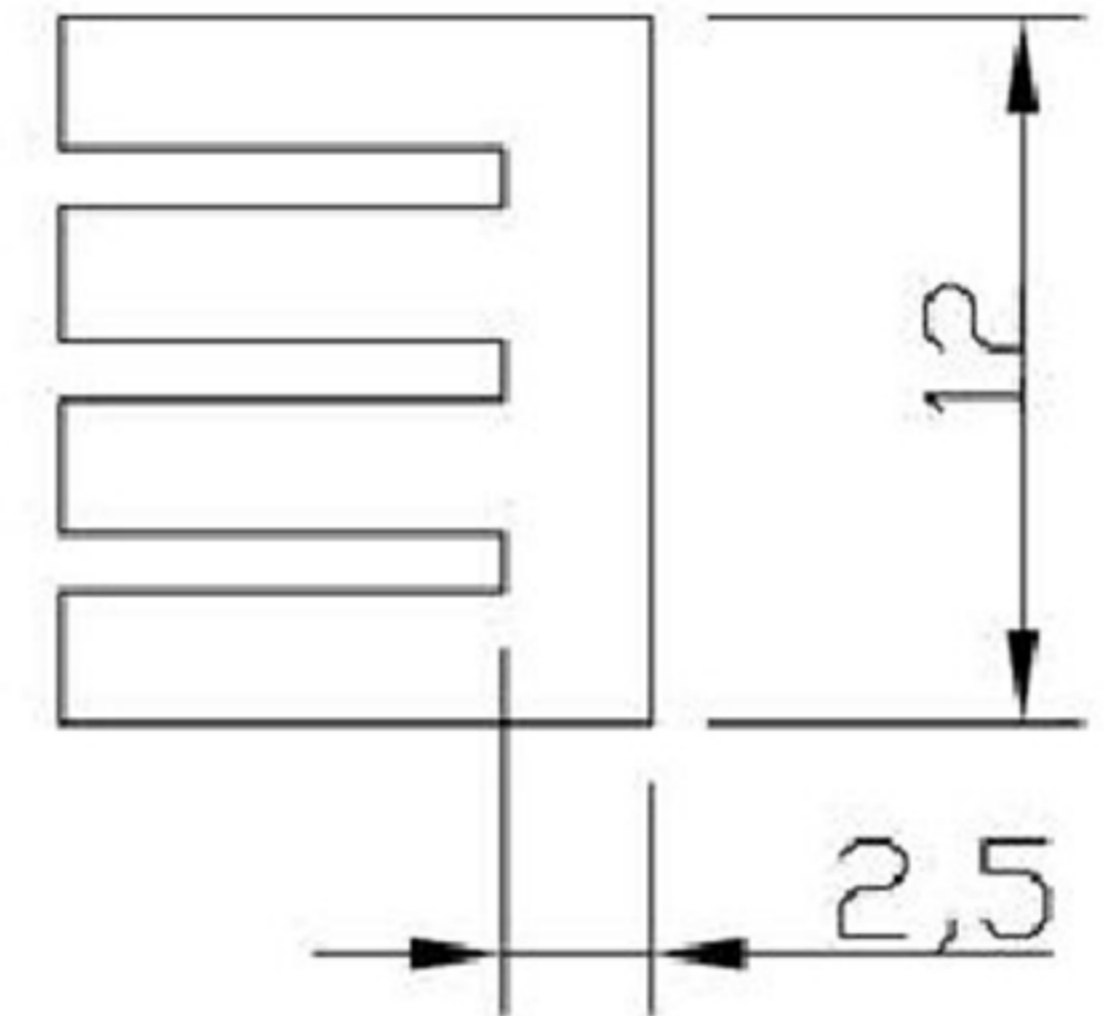
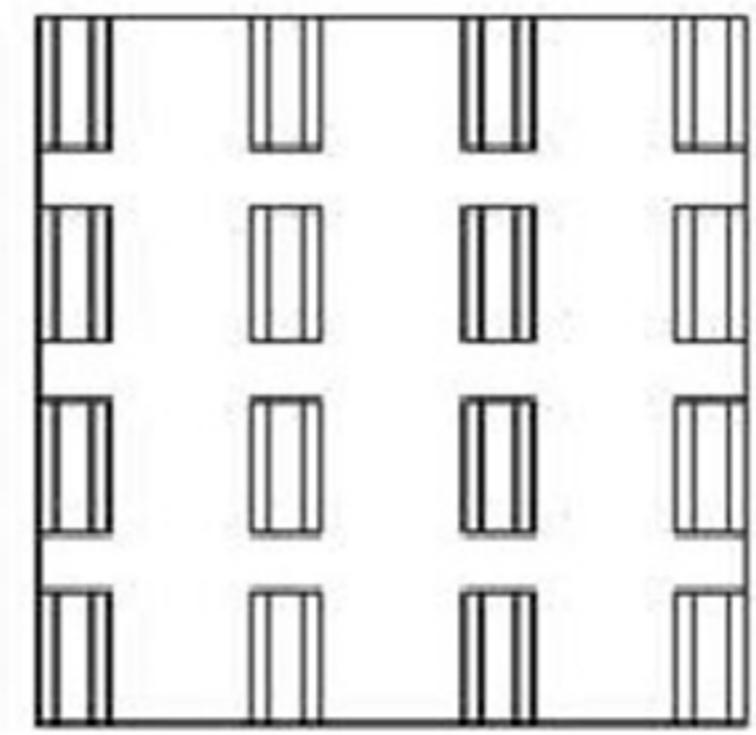

ALL DIMENSIONS ARE IN MM		MATERIAL: AL 6063-T5			
UNLESS NOTED OTHERWISE TOLERANCES: DIM: ± 0,1 ANG: ± 0,5 HOLE: ± 0,05 DO NOT SCALE DRAWING		FINISH: BLACK ANODIZED DRAWN BY: --- CHECKED BY: --- CREDITS BY: ---			
CONDUCTIVITY = 400 W/MK $\sqrt{R} = 16 \mu\text{M FINISH}$ ALL THREADS CLASS 2 PERPENDICULARITY & PARALLELISM AS REMOVE SHARP EDGES AND BURRS THIRD ANGLE PROJECTION		DATE: 25-04-2011		COOLING SOURCE PART NUMBER: CH083C3T4121DC1 COOLING SOURCE PART NUMBER: ---	